

- NOTES:
- 1. SUBSTRATE:  
D263@T eco
  - 2. COATING (APPLY ACROSS CLEAR APERTURE)  
S1 & S2: NONE
  - 3. FINE GROUND
  - 4. ROHS COMPLIANT

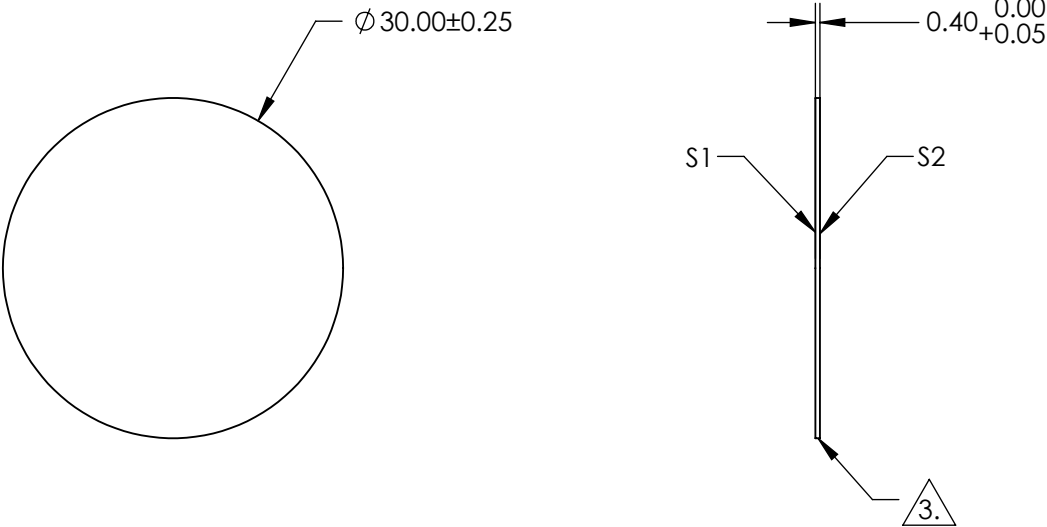
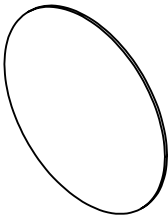

**FOR INFORMATION ONLY:**  
**DO NOT MANUFACTURE**  
**PARTS TO THIS DRAWING**

SPECIFICATIONS SUBJECT TO CHANGE WITHOUT NOTICE  
DIMENSIONS ARE FOR REFERENCE ONLY

**EO**® **Edmund Optics®**

	S1	S2
SHAPE	PLANO	PLANO
SURFACE QUALITY	80 - 50	80 - 50
CLEAR APERTURE	Ø 27.00	Ø 27.00
BEVEL	PROTECTED AS NEEDED	PROTECTED AS NEEDED



ALL DIMS IN mm

TITLE	30mm Dia., 0.4mm Thick, SCHOTT D263@T eco Window		
DWG NO	29360	SHEET 3 OF 12	